

## ZONE 3 WEST MORELAND

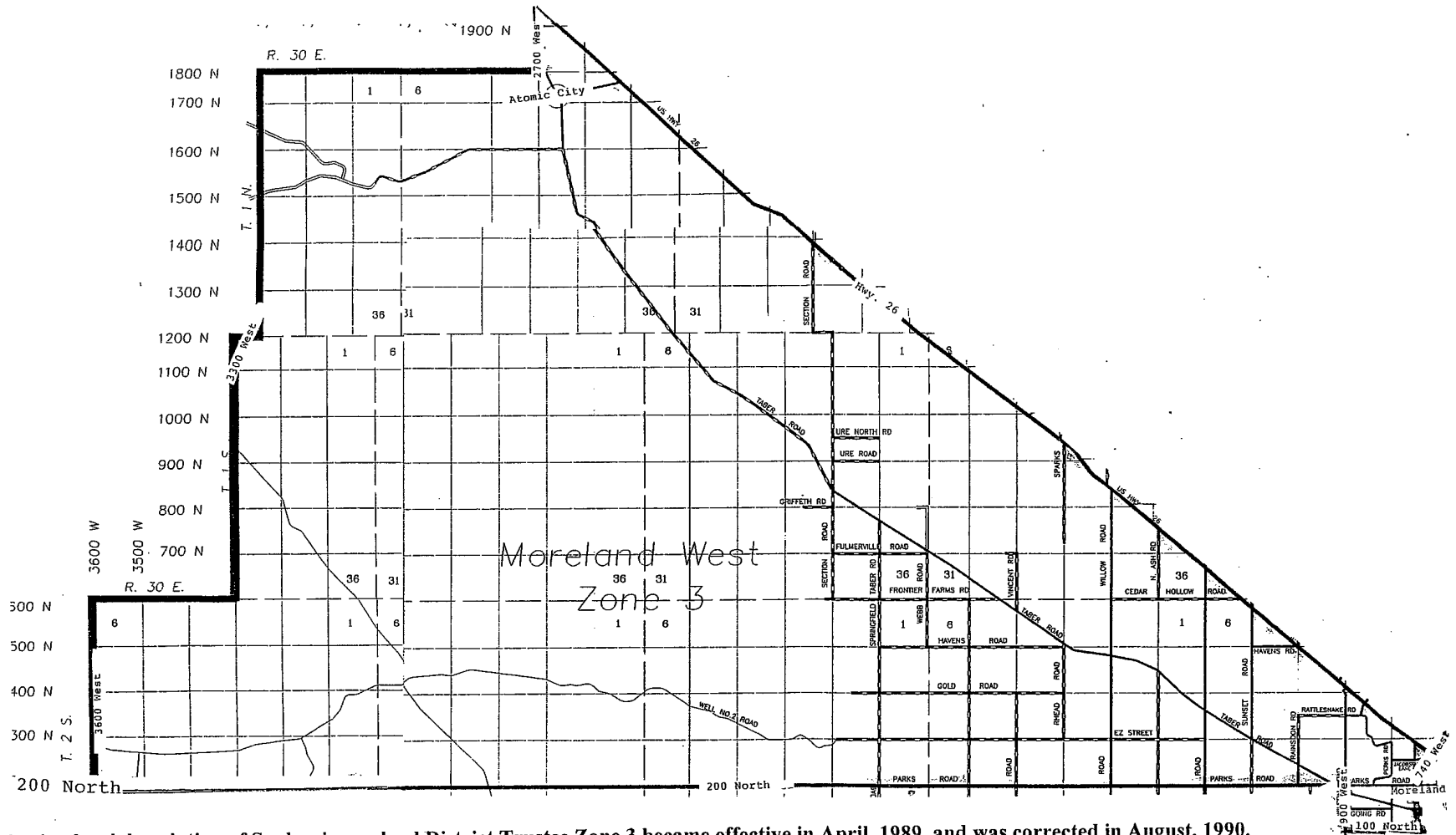

The following legal description of Snake river school District Trustee Zone 3 became effective in April, 1989, and was corrected in August, 1990.

The legal description of Zone 3 is as follows:

Beginning on the west district boundary at the intersection of 2700 West and Highway 26, then southeast on Highway 26 to 740 West or Moreland Road, including all residences on the south side of Highway 26; then south on 740 west (Moreland Road) to 100 North, including all residences on the west side of 740 West (Moreland Road); then west on 100 North to 900 West, including all residences on the north side of 100 North; then north on 900 West to 200 North, including all residences on the east side of 900 West; then west on 200 North to the district boundary at 3600 West, including all residences on the north side of 200 North; then following the district boundary, north on 3600 West to 600 North; then east on Bingham County boundary 600 North to 3300 West; then north on Bingham County boundary 3300 West to 1200 North; then east one-half mile on 1200 North; then north on Bingham County boundary to 1800 North; then east on Bingham County boundary 1800 North to 2700 West; then north on 2700 West to its intersection with Highway 26, the point of beginning.

2001 Census shows population for this Zone to be: 1574